

**SMD POWER INDUCTORS: HSC6012 Series**

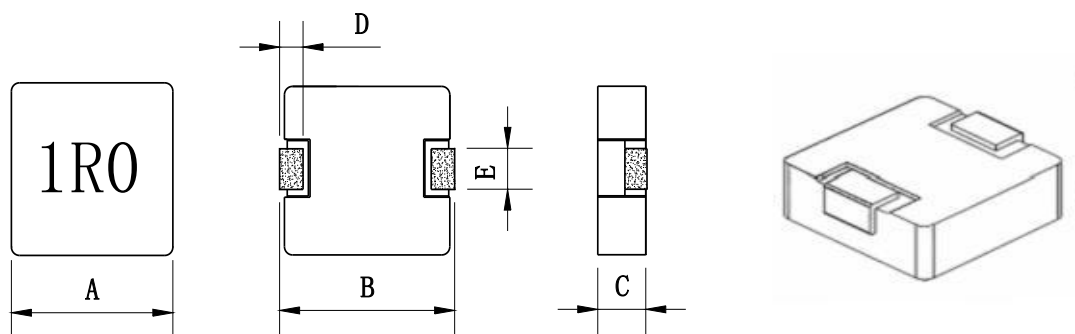

Series	A (mm)	B (mm)	C (mm)	D (mm)	E (mm)
HSC6012	6.6 ± 0.2	7.4MAX	1.2MAX	1.6 ± 0.3	3.0 ± 0.2

Part Number	L0 Inductance (μH) ± 20%	Heat Rating Current Irms (A)	Saturation Current Isat (A)	DCR (mΩ)	
				TYP.	MAX.
HSC6012-R56M-G/B	0.56	6.0	11.0	13.5	16.0
HSC6012-R68M-G/B	0.68	5.5	10.0	14.7	17.0
HSC6012-R82M-G/B	0.82	5.0	9.0	19.1	22.0
HSC6012-1R0M-G/B	1.0	6.0	7.0	22.3	26.0
HSC6012-2R2M-G/B	2.2	3.5	5.0	64.0	67.0
HSC6012-3R3M-G/B	3.3	3.0	4.0	80	92.0
HSC6012-4R7M-G/B	4.7	2	3.5	120.0	130.0
HSC6012-100M-G/B	10.0	1.5	2.5	250.0	290.0

\*: you require another part number please contact with us.

\*\* : Inductance Tolerance ± 20%

Note 1: All test data is referenced to 25°C ambient.

Note 2: I<sub>dc</sub> : DC current (A) that will cause an approximate ΔT of 40°C

Note 3: I<sub>sat</sub> : DC current (A) that will cause L<sub>o</sub> to drop approximately 30%

# SMD POWER INDUCTORS:

HSC-6012M Series

## 1. Reel Dimension

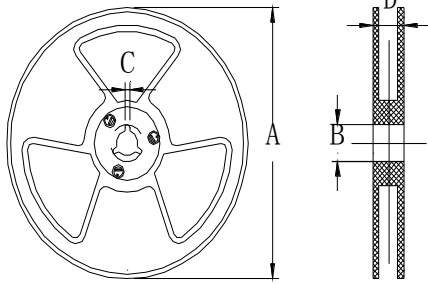

规格尺寸	13"
A	$\Phi 330 \pm 2.0\text{mm}$
B	$\Phi 76.5 \pm 2.0\text{mm}$
C	2.3mm
D	16mm (载带 $13.3 \pm 0.15\text{mm}$ )

## 2. Tape Dimension

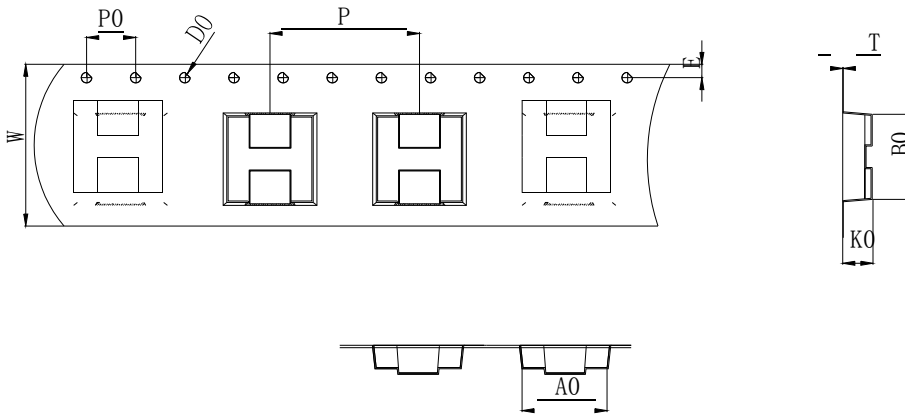

Size	W (mm)	A0 (mm)	B0 (mm)	D0 (mm)	E (mm)	K0 (mm)	P0 (mm)	P (mm)	T (mm)
6012	$16.0 \pm 0.3$	$6.8 \pm 0.1$	$7.3 \pm 0.1$	$1.5 \pm 0.1$	$1.75 \pm 0.1$	$1.2 \pm 0.1$	$4.0 \pm 0.1$	$12.0 \pm 0.1$	$0.3 \pm 0.05$

## 3. Packaing Quantity

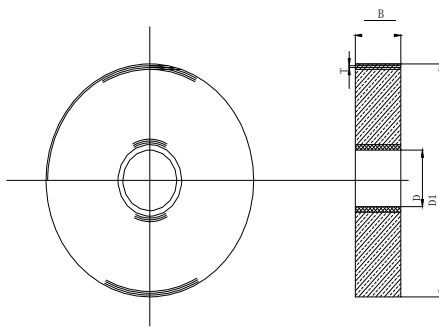

包装单位	包装尺寸	包装数量
1 盘	330*29mm	3000pcs
1 盒3 盘	34*6.5*34cm	9000pcs
1 箱2 盒	35.5*28.5*36.5cm	18000pcs