

## SMD POWER INDUCTORS: HSC1770 Series

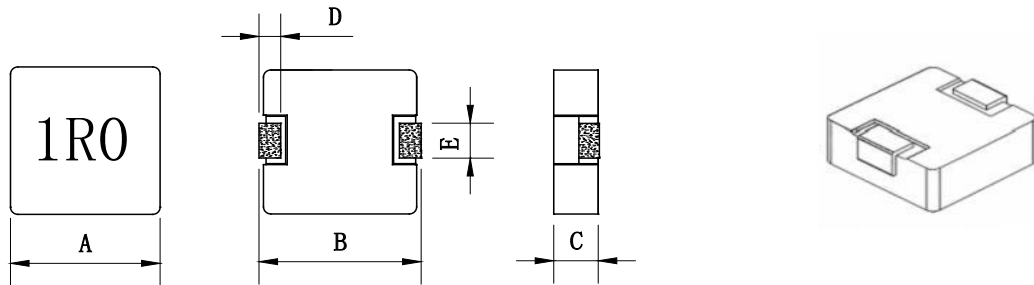

Series	A (mm)	B (mm)	C (mm)	D (mm)	E (mm)
HSC1770	17.5±0.5	17.15MAX	7.0MAX	2.5±0.5	11.94±0.3

Part Number	L0 Inductance (μH) ±20%	Heat Rating Current Irms (A)	Saturation Current Isat (A)	DCR (mΩ)	
				TYP.	MAX.
HSC1770-1R5M-G/B	1.5	23.0	45.0	1.45	1.85
HSC1770-2R2M-G/B	2.2	20.0	40.0	2.5	3.2
HSC1770-4R7M-G/B	4.7	15.0	30.0	3.4	4.1
HSC1770-6R8M-G/B	6.8	13.0	26.0	5.8	6.55
HSC1770-8R2M-G/B	8.2	12.0	24.0	8.1	9.5
HSC1770-100M-G/B	10.0	11.0	22.0	9.8	11.0
HSC1770-150M-G/B	15.0	10.0	20.0	14.5	15.5
HSC1770-220M-G/B	22.0	7.0	14.0	20.5	28.0
HSC1770-330M-G/B	33.0	6.0	12.0	34	45.0
HSC1770-470M-G/B	47.0	5.0	10	41	55.0
HSC1770-680M-G/B	68.0	5.0	9.0	69.0	80.0
HSC1770-820M-G/B	82.0	4.5	8	89	96.0
HSC1770-101M-G/B	68.0	4.0	7.0	104.0	115.0

\*: you require another part number please contact with us.

\*\* : Inductance Tolerance ± 20%

Note 1: All test data is referenced to 25°C ambient.

Note 2: Idc : DC current (A) that will cause an approximate ΔT of 40°C

Note 3: Isat : DC current (A) that will cause Lo to drop approximately 30%

# SMD POWER INDUCTORS:

HSC-1270M Series

## 1. Reel Dimension

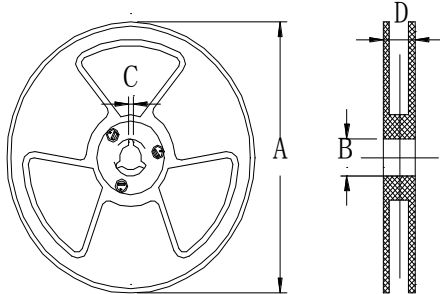

规格尺寸	13"
A	$\Phi 330 \pm 2.0$ (mm)
B	$\Phi 76.5 \pm 2.0$ mm
C	$\Phi 2.3$ mm
D	24.0 上载带 21.3 $\pm 0.15$ mm)

## 2. Tape Dimension

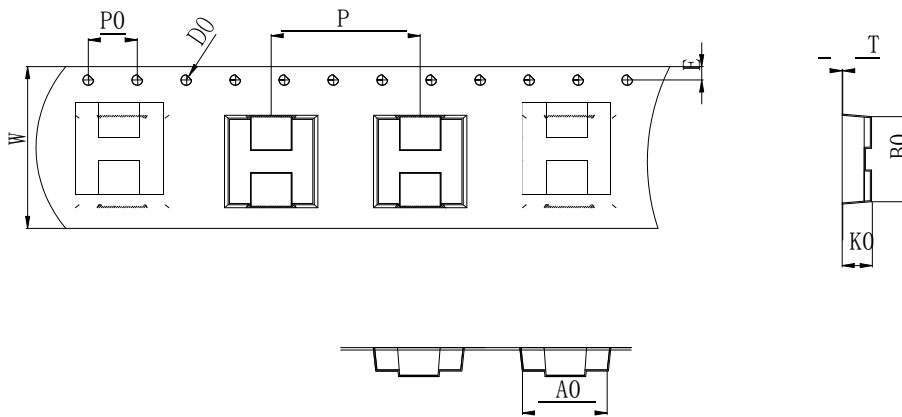

Size	W (mm)	A0 (mm)	B0 (mm)	D0 (mm)	E (mm)	KO (mm)	P0 (mm)	P (mm)	T (mm)
1270	24.0 $\pm 0.3$	13.1 $\pm 0.1$	14.1 $\pm 0.1$	1.5 $\pm 0.1$	1.75 $\pm 0.1$	7.0 $\pm 0.1$	4.0 $\pm 0.1$	20.0 $\pm 0.1$	0.4 $\pm 0.05$

## 3. Packaing Quantity

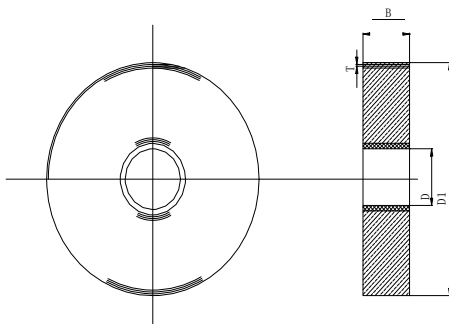

包装单位	包装尺寸	包装数量
1 盘	330*29mm	500pcs
1 盒/2 盘	34*6.5*34cm	1000pcs
1 箱/2 盒	35.5*28.5*36.5cm	2000pcs